

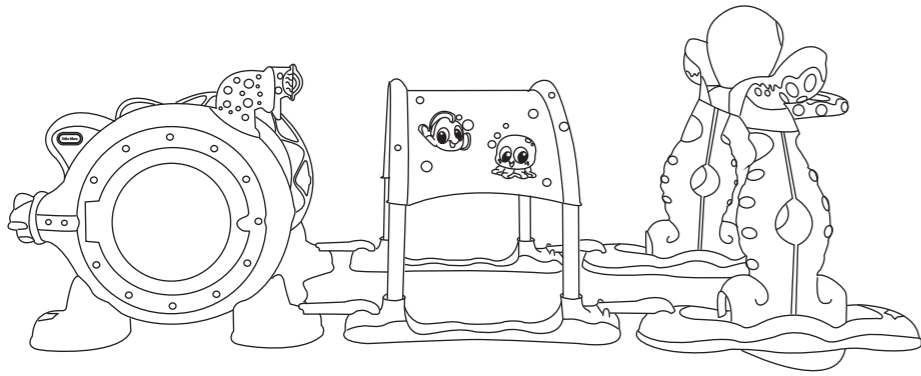

# lil' ocean explorers™ 3 in 1 Adventure Course™

AGES 6-36 MONTHS  
ADULT ASSEMBLY AND SUPERVISION REQUIRED.  
ADULT BATTERY INSTALLATION REQUIRED.

638466



Illustrations are for reference only. Styles may vary from actual contents.

## CONTENTS

- |   |                         |                         |
|---|-------------------------|-------------------------|
| A. 1 Left Submarine Wall with submarine wheel | H. 1 Cross Beam         | P. 1 Octopus Head       |
| B. 1 Right Submarine Wall                     | I. 1 Fabric Canopy      | Q. 1 Octopus Handle     |
| C. 1 Rear Submarine Base                      | J. 2 Propeller Spinners | R. 2 Octopus Arms       |
| D. 1 Front Submarine Base                     | K. 1 Left Tunnel Base   | S. 1 Left Octopus Leg   |
| E. 4 Connectors                               | L. 1 Right Tunnel Base  | T. 1 Right Octopus Leg  |
| F. 1 Front Arch                               | M. 1 Curly Ring         | U. 1 Left Octopus Base  |
| G. 1 Rear Arch                                | N. 1 Hanging Jellyfish  | V. 1 Right Octopus Base |
|   | O. 4 Balls              | W. 20 Screws            |
|   |                         | X. 4 Screws             |
|   |                         | Y. 1 Mirror Spinner     |

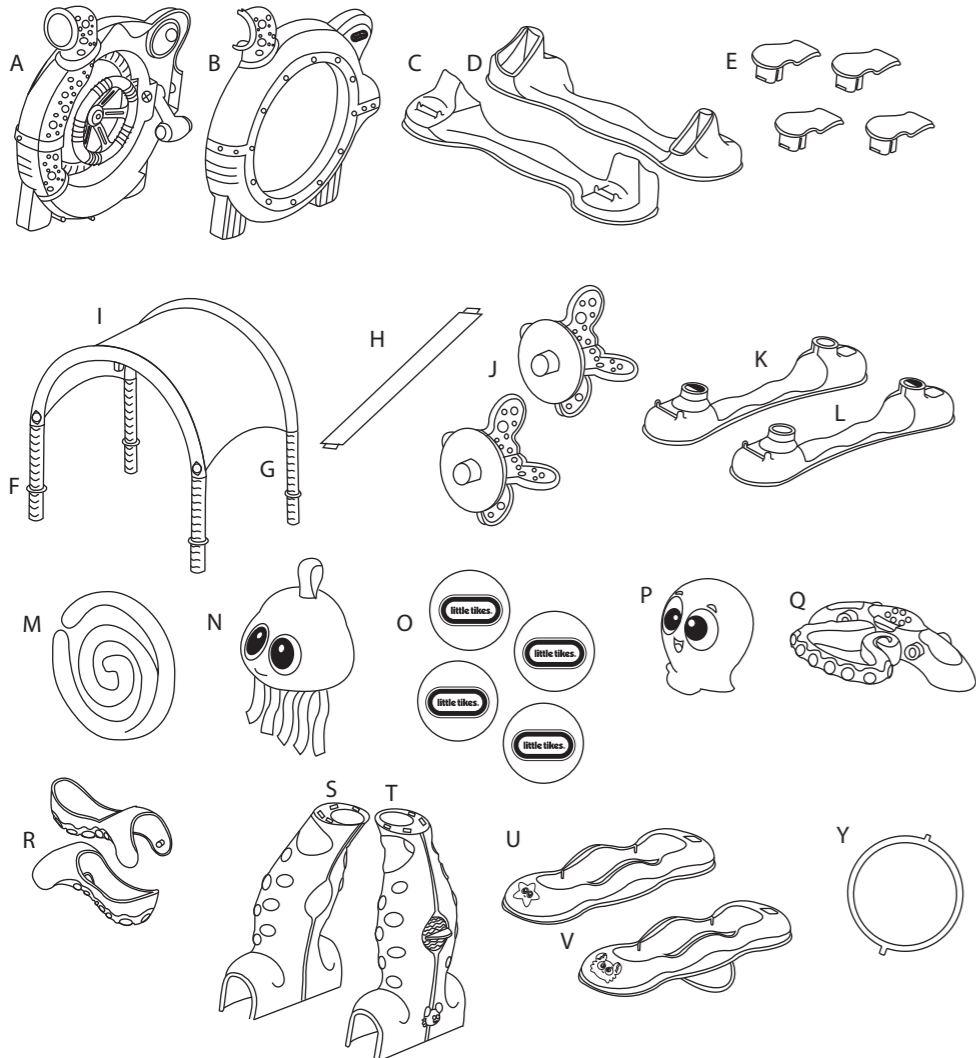
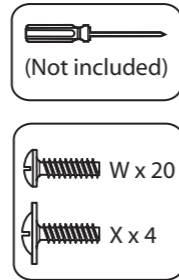

## BATTERY INSTALLATION

- Prior to playing, an adult must install fresh alkaline batteries (not included). Here's how:
- Using a Phillips screwdriver (not included) remove the screw and battery compartment cover from the bottom of the octopus handle.
  - Insert two (2) AA alkaline batteries (not included) making sure the (+) and (-) ends face the proper direction as indicated inside the battery compartment.
  - Replace the compartment cover and tighten the screw.

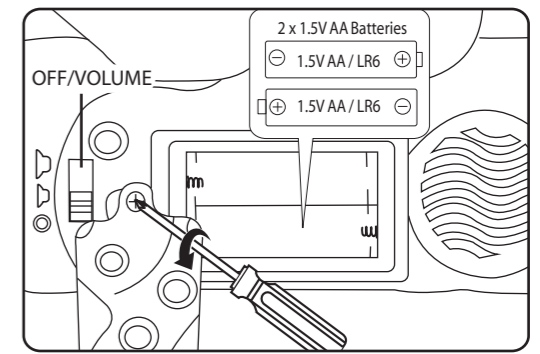

## SUBMARINE ASSEMBLY

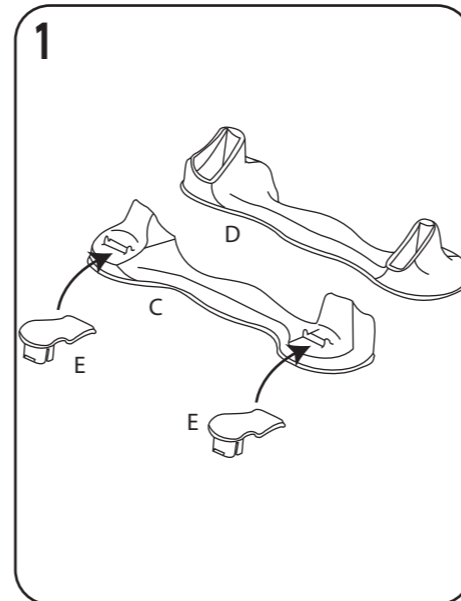

1. Snap two connectors (E) onto the rear submarine base (C).

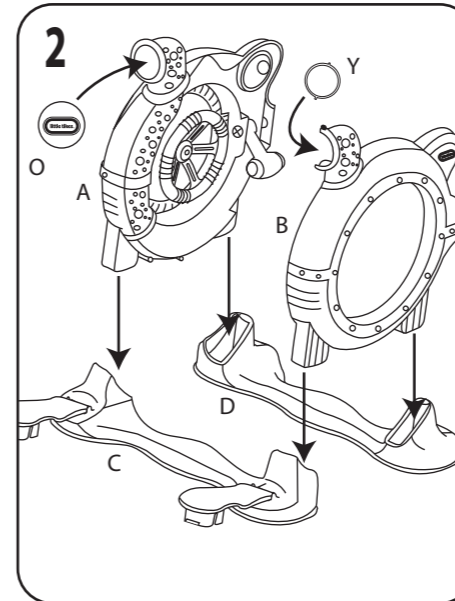

2. Snap the submarine walls (A, B) into the bases (C, D). Snap the mirror spinner (Y) onto the periscope on the right submarine wall (B).

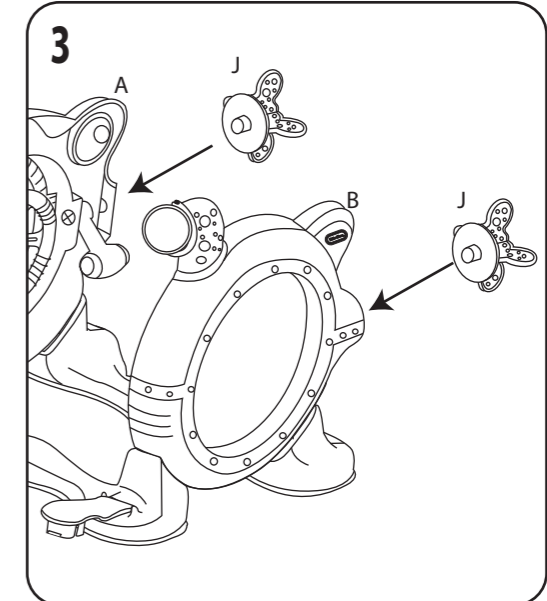

3. Snap the propeller spinners (J) onto the sides of the submarine walls.  
NOTE: Propellers cannot be removed once installed.

## TUNNEL ASSEMBLY

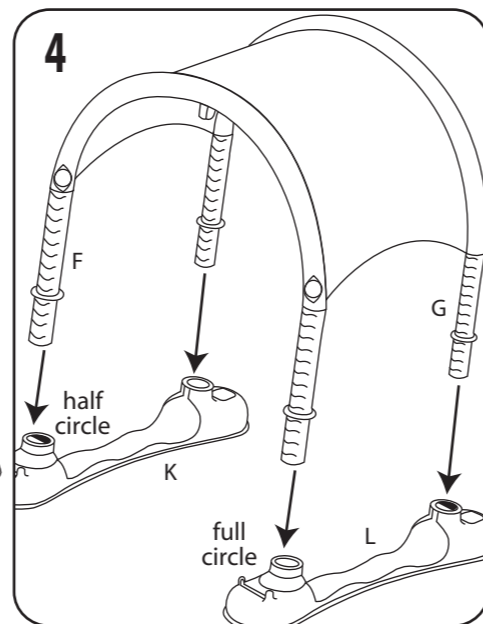

4. Snap the arches (F, G) into the tunnel bases (K, L), matching the half circle and full circle arch bottoms with openings on the tunnel bases.

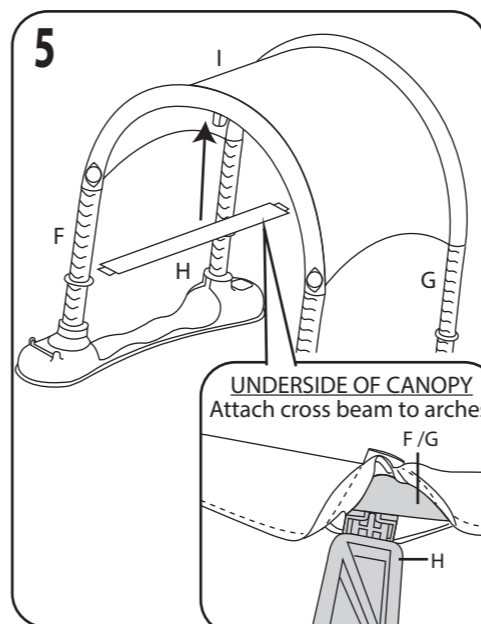

5. Attach the cross beam (H) to both arches (F, G) under the canopy (I).

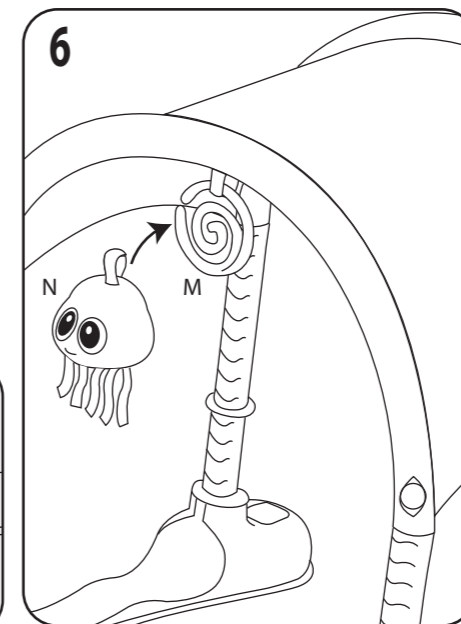

6. Slide the curly ring (M) through the loop on the front of the canopy. Then, slide the loop on the hanging jellyfish (N) over the bottom of the curly ring.

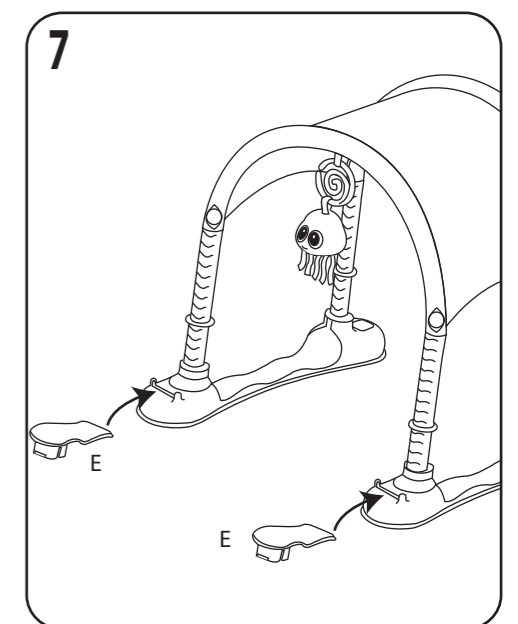

7. Snap two connectors (E) onto the front of the tunnel bases.

## OCTOPUS ASSEMBLY

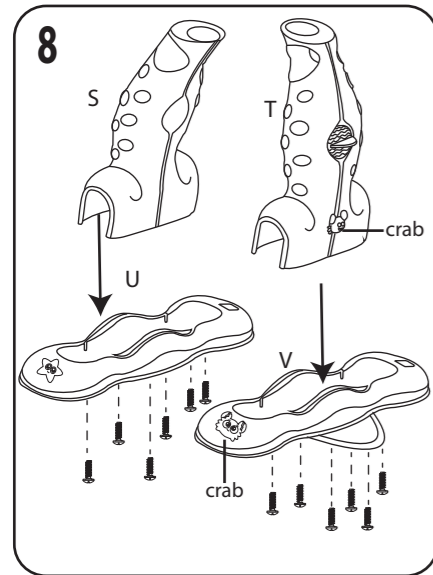

8. Snap the octopus legs (S, T) into the octopus bases (U, V) and secure each leg with 6 screws (W). Hint: Match the crab on the base to the crab slider on the leg. Do the same for the starfish to make sure the legs and bases align.

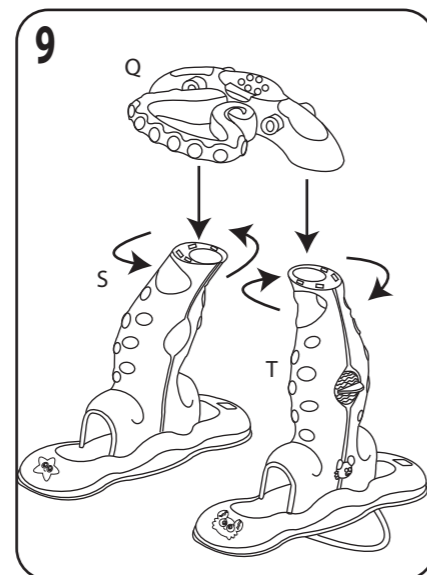

9. Fit the pegs on the octopus legs into the openings on the octopus handle (Q). Twist the legs to lock them in place.

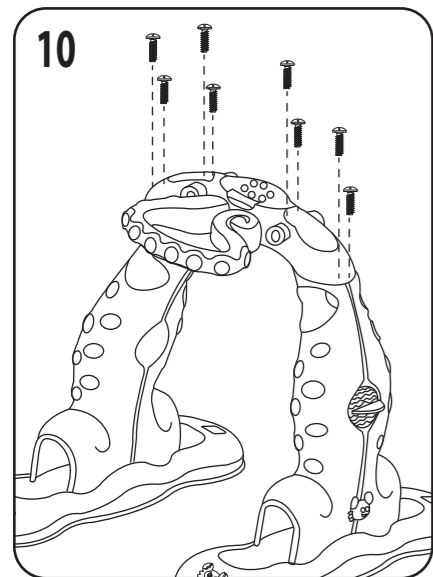

10. Secure the handle to the legs with eight screws (W).

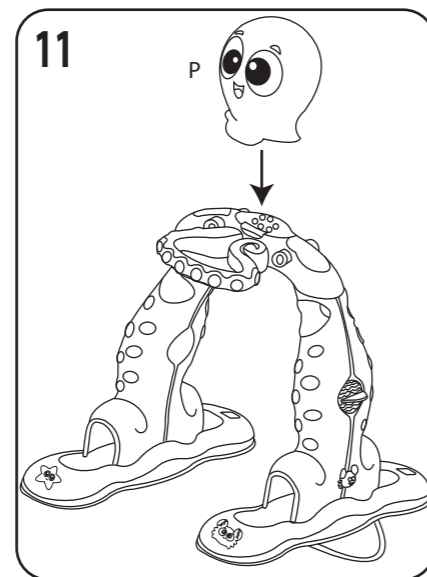

11. Snap the octopus head (P) into place.

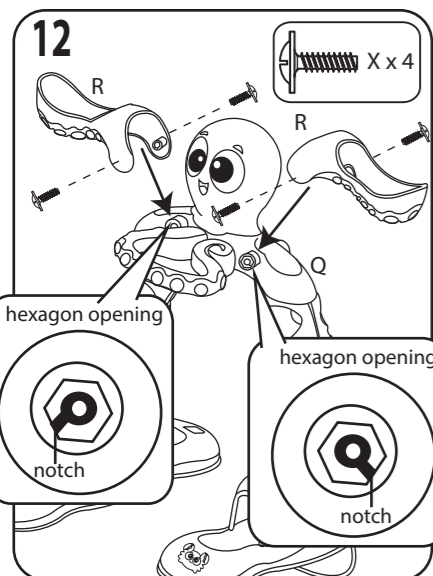

12. With your finger, turn the hexagon openings on the front of octopus handle (Q) to the positions shown above. Then, snap the octopus arms (R) into place, and secure each arm with two screws (X).

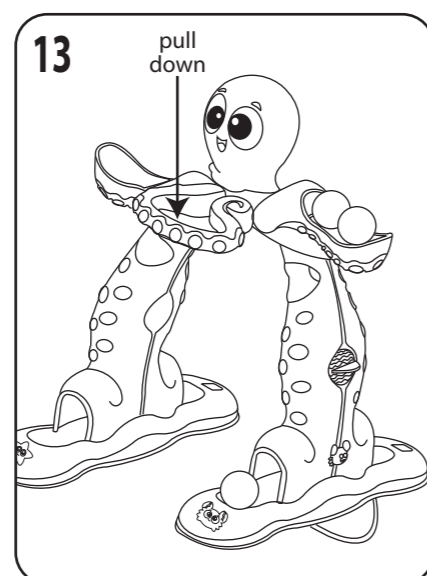

13. Move the switch under the octopus handle to low volume or high volume to hear fun sounds! Place balls (O) in the octopus arms, pull down on the handle and watch the balls drop into the bases! (See "BATTERY INSTALLATION" for switch location.)

## ADVENTURE COURSE

Configure the course multiple ways by attaching each section with the connectors.

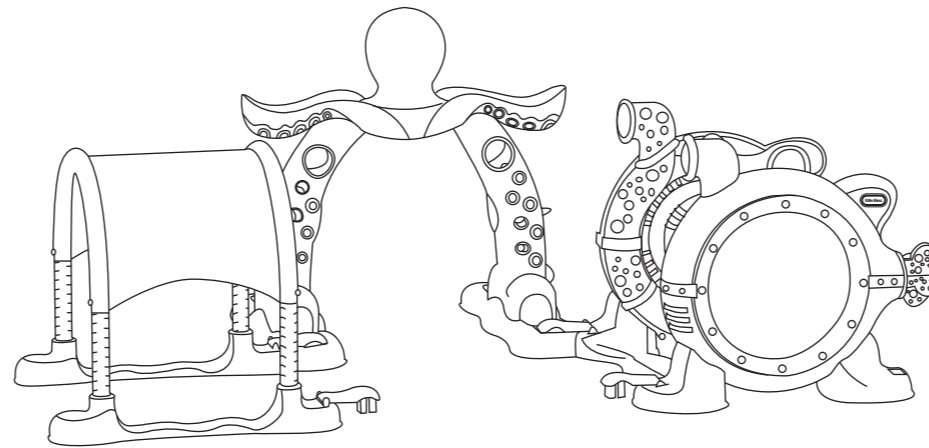

**WARNING**

### ADULT ASSEMBLY REQUIRED

- Prior to assembly, this package contains small parts: hardware which is a choking hazard and may contain sharp edges and sharp points. Keep away from children until assembled.
- Read all instructions before assembly and use of the 3 in 1 Adventure Course™.
- Never leave child unattended. Always keep child in view while using the 3 in 1 Adventure Course™.
- Place product on a flat, level surface free of objects.
- DO NOT suspend strings over product or attach strings to toys.
- Do not use the 3 in 1 Adventure Course™ if it is damaged or broken.
- Do not use until baby / child can sit up by itself. This 3 in 1 Adventure Course™ is only intended for use with children who can sit upright unassisted at approximately 6 months of age.
- Do not expose the 3 in 1 Adventure Course™ to liquid of any kind as moisture may damage the unit. Wipe clean with a damp cloth only.
- Constant, competent adult supervision is required while child is using the unit.



**WARNING:** Not to be used by children over 36 months due to size limitations.

## IMPORTANT INFORMATION

- Always turn the switch to the "OFF" position after playing to conserve battery life.
- DO NOT expose the unit to moisture of any kind. This item is not intended for use in water.
- Only use the balls included with this product or other Little Tikes® Lil' Ocean Explorers™ products.
- In the event of a malfunction, reset the item by removing and replacing the batteries.
- If function is still not restored, replace the batteries with fresh alkaline batteries.

## BATTERY SAFETY INFORMATION

- Charging of rechargeable batteries should only be done under adult supervision. Use only size AA (LR6) alkaline batteries (2 required).
- Never mix old batteries with new batteries, rechargeable (nickel-cadmium) or carbon zinc with alkaline batteries.
- Be sure to insert the batteries correctly and follow the toy and battery manufacturer's instruction.
- Always remove exhausted or dead batteries from the product.
- Dispose of dead batteries properly: do not burn or bury them.
- Do not attempt to recharge non-rechargeable batteries.
- Remove rechargeable batteries from the product before recharging.
- Charging of rechargeable batteries should only be done under adult supervision with batteries removed from product.
- Avoid short-circuiting battery terminals.
- Remove batteries before placing the unit into storage for a prolonged period of time.

## FCC COMPLIANCE

NOTE: This equipment has been tested and found to comply with the limits for a Class B digital device, pursuant to Part 15 of the FCC Rules. These limits are designed to provide reasonable protection against harmful interference in a residential installation. This equipment generates, uses and can radiate radio frequency energy and, if not installed and used in accordance with the instructions, may cause harmful interference to radio communications. However, there is no guarantee that interference will not occur in a particular installation. If this equipment does cause harmful interference to radio or television reception, which can be determined by turning the equipment off and on, the user is encouraged to try to correct the interference by one or more of the following measures:

- Reorient or relocate the receiving antenna.
- Increase the separation between the equipment and receiver.
- Connect the equipment into an outlet on a circuit different from that to which the receiver is connected.
- Consult the dealer or an experienced radio/TV technician for help.

This device complies with Part 15 of the FCC Rules. Operation is subject to the following two conditions: (1) This device may not cause harmful interference, and (2) this device must accept any interference received, including interference that may cause undesired operation.

Caution: Modifications not authorized by the manufacturer may void users authority to operate this device.

CAN ICES-3 (B)/NMB-3(B).

## LIMITED WARRANTY

The Little Tikes Company makes fun, high quality toys. We warrant to the original purchaser that this product is free of defects in materials or workmanship for one year \* from the date of purchase (dated sales receipt is required for proof of purchase). At the sole election of The Little Tikes Company, the only remedies available under this warranty will be the replacement of the defective part or replacement of the product. This warranty is valid only if the product has been assembled and maintained per the instructions. This warranty does not cover abuse, accident, cosmetic issues such as fading or scratches from normal wear, or any other cause not arising from defects in material and workmanship. \*The warranty period is three (3) months for daycare or commercial purchasers.

U.S.A and Canada: For warranty service or replacement part information, please visit our website at [www.littletikes.com](http://www.littletikes.com), call 1-800-321-0183 or write to: Consumer Service, The Little Tikes Company, 2180 Barlow Road, Hudson OH 44236, U.S.A. Some replacement parts may be available for purchase after warranty expires—contact us for details.

Outside U.S.A and Canada: Contact place of purchase for warranty service. This warranty gives you specific legal rights, and you may also have other rights, which vary from country/state to country/state. Some countries/states do not allow the exclusion or limitation of incidental or consequential damages, so the above limitation or exclusion may not apply to you.



'Let's care for the environment!'

The wheeled bin symbol indicates that the product must not be disposed of with other household waste. Please use designated collection points or recycling facilities when disposing of the item.

Do not treat old batteries as household waste. Take them to a designated recycling facility.

Please keep this manual as it contains important information.



0815-2-E/INT

© The Little Tikes Company, an MGA Entertainment company. LITTLE TIKES® is a trademark of Little Tikes in the U.S. and other countries. All logos, names, characters, likenesses, images, slogans, and packaging appearance are the property of Little Tikes.  
Little Tikes Consumer Service  
2180 Barlow Road  
Hudson, Ohio 44236 U.S.A.  
1-800-321-0183  
Printed in China

MGA Entertainment UK Ltd.  
50 Presley Way  
Crownhill  
Milton Keynes  
MK8 0ES  
Bucks, UK  
0800 521 558



Visit our website at [www.littletikes.com](http://www.littletikes.com) to register your product and to enter our sweepstakes. (No purchase necessary)

[www.littletikes.com](http://www.littletikes.com)  
[www.littletikes.co.uk](http://www.littletikes.co.uk)